



BEAUTIFUL, BESPOKE GARDEN ROOMS



TABLE OF

CONTENTS

About Haon Garden Room	04
Our Haon Values & Process	05
Garden Offices	08
Garden Gyms	12
Garden Yoga & Pilates studios	16
Garden Bars	18
Garden Multi-use entertainment spaces	23
Garden Beauty & Aesthetic studios	26
Hobby & Creative Studios	28
Bespoke design	30
Bespoke interior design	33
Hand Picked Partners & Haon Garden Rooms	36
Guarantee	37
The Haon process	38
Technical Information	39
Our showroom & how to find us	40
Customer reviews	42
Our people	43



WELCOME TO HAON GARDEN ROOMS:

AT HAON GARDEN ROOMS WE PRIDE OURSELF ON BEING A WELL-ESTABLISHED AND TRUSTED, BESPOKE, GARDEN ROOM COMPANY OFFERING THE FULL PACKAGE WITH FIVE STAR SERVICE!

Born out of a love for beautifully unique designs and construction, the award winning Haon Garden Rooms was established in 2020 when the owners felt that no other garden room companies provided a truly bespoke design and installation service, including project management, especially when it differed from the traditional rectangular or square shapes.

Therefore Haon Garden Rooms was created to give you, our client, exactly what you want; project managed from the beginning to the very

end, designed and built precisely to your individual style and requirements, and offering you a wide choice of double glazed uPVC windows and doors, interiors and lighting, Cedar, Hardie Plank or Composite fascias and decking, along with some of the latest innovative products.

We work with you to design and build your unique Garden Room, whether it be an office, gym, studio, multi-use entertainment space or bar, we do it all for you!

Haon Garden Rooms can help you achieve your dream, and create your perfect space.



OUR HAON VALUES MAKE THE DIFFERENCE

From the very start we have always believed that a garden room can, and should be, an asset to every home. And just like every person, no two Haon garden rooms are ever the same.

From the moment that Haon Garden Rooms was conceived, we have always strived for excellence and believe so highly in our materials and workmanship that we back this up with our 10 and 15 year guarantees.

As our Managing Director, Jason Mennie says,

“High standards, quality materials and excellent customer service is paramount. This, along with designing and building their dream garden room, is the very minimum we offer all our clients!”





GARDEN OFFICES

THINK OUT OF THE BOX!

Haon Garden Room offices are completely bespoke and no two offices are ever the same.

With internal space being just as important as external, we believe a garden office should be a place of tranquillity as well as productivity. Therefore we work with our clients to design a size and shape to sit perfectly into their space, creating a garden office of functionality as well as aesthetical beauty.

Garden offices are fully insulated and are for all-year-round use, and can even be

built with a kitchenette and a cloakroom (toilet and wash-hand basin). By adding a separate room, or two, for storage or a cloakroom, this really creates a fully functional office for multiple people.

Even by optimizing unusual or difficult spaces you can have a great garden office. All our garden offices are fully insulated, decorated, and fitted with electrics and internet. All you need to do is simply unlock the door and walk in!









A PERFECT WORK LIFE BALANCE

Sometimes the line between work and family-life can become blurred, so the key to a work-life balance is having a completely separate working space.

Without having to compromise your time by sitting in heavy traffic or on public transport, and by reclaiming your spare bedroom, or not having to clear away a work-pile from your dining-room table, a Haon Garden Room office is the perfect way to achieve this with the added benefit of no interruptions for those all important Teams or Zoom meetings.

And, for maximum safety and security, all our garden rooms come with uPVC doors and windows fitted with multi point locks so everything inside is kept safe, secure, and protected.

With a garden office you can just walk out your door and you're already at work! And then, at the end of the day, you can simply lock the door and completely switch off.

GARDEN GYMS

WHAT CAN BE BETTER THAN TO ESCAPE TO YOUR OWN PRIVATE GYM?

Garden Gyms are fast becoming an absolute must for the discerning gym-goer or health enthusiast. With double glazed units and hybris insulation in the walls, ceiling and floor, Haon garden gyms can be used comfortably any time of the year, and in any weather.

A bespoke Garden Gym can give you exactly what you want; designed and built precisely to your individual requirements with a wide choice of double glazed uPVC windows and French, sliding or bi-fold doors, specialist flooring, lighting, mirrors, additional ceiling height (if required), and toilet and shower facilities. so much more.

So, what's better than no commute to the gym?

- No monthly or annual membership fees,
- Running on your treadmill as you look out across your garden
- Working out at your own pace without the pressure of having to give up your machine to someone else,
- Working-out with your personal trainer in a more private environment, or want to offer personal trainer sessions?
- Being able to work-out whenever you want, and all year round with a toasty wall-mounted heater or refreshingly-cool air-conditioning unit.

All this and so much more is what you get with a Haon Garden Gym!







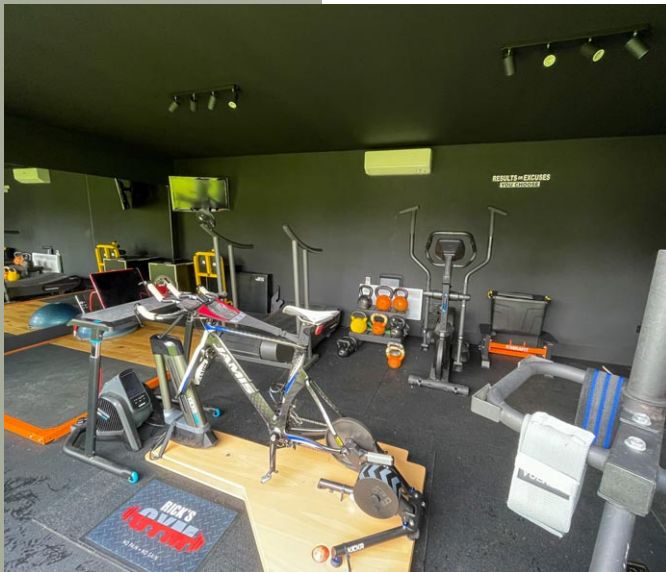

YOGA & PILATES STUDIOS:

Imagine doing the Sun Salutation on the deck of your very own Yoga studio as the sun rises or sets. And then meditating in the warmth of your peaceful studio, with only the tranquil music from your speakers and not another sound around.

Or, if Pilates is your thing, wouldn't you like to do your Reformer Workout in your very own Pilates studio, built and designed exactly the way you want?

With your very own bespoke Yoga or Pilates studio, you can complete your zen workout in peace and quiet. No commute, not intrusive people around. Just serenity and space to workout your way, whenever you want.

Pure bliss!





GARDEN BAR

With more people choosing to entertain at home, a garden bar provides you with the perfect space to have your favourite beers on tap, to serve those all-important cocktails, or shoot some pool with your friends and family.

Haon Garden Rooms gives you the flexibility to completely customise the shape, size and design of your garden bar, as well as having

- a built-in-bar with fridge,
- a unique feature-wall,
- a sound system for your flat screen TV,
- or even a cute little cloak room with toilet and basin,

.... all installed at the same time.

Whether it's a place to relax and watch the football, have a drink with your friends, or enjoy a romantic night or two with your partner, a Haon garden bar would make a fantastic addition to any garden, and, with our completely bespoke service, we have endless options to make your garden bar as unique and fabulous as you are!













MULTI USE GARDEN ROOM

CREATE THE PERFECT SPACE FOR THE WHOLE FAMILY TO ENJOY.

A Haon Garden Multi-Use room is a space that can be enjoyed by everyone. Our garden rooms are unique and incredibly adaptable, so they can be utilised for a wide variety of uses.

From a teenager's den to a man cave, or a reading room or traditional garden room as well as so much more, your Multi-Use garden room can really be anything you want.

Double glazing and hybris insulation in the walls, ceiling and floor your Multi-Use room can be used comfortably any time of year. For those chillier days, all our rooms come with an electric wall heater fitted as standard, and air conditioning is offered as

an upgrade for those hot summer months to keep you feeling refreshingly cool.

Our wide choice of doubled glazed uPVC windows and French, sliding, or bi-fold doors, are all fitted with multi-point locks so everything inside is kept safe, secure, and protected, whilst making sure your garden room is flooded with as much natural light as possible, whilst taking advantage of your beautiful garden views.

And to give your multi-use garden room that extra wow factor, we can even add a kitchenette or ensuite, specialised flooring, a feature wall and so much more!

We really do create the perfect relaxation or entertainment spaces.





GARDEN BEAUTY, HAIR & AESTHETIC STUDIOS

Utilising a space in your garden, regardless of its shape, can transform into an excellent and functional beauty, hair, or aesthetics studio. Insulated garden rooms have become increasingly popular for home-based businesses, particularly in the booming beauty industry. This approach is an efficient way to minimise overheads without sacrificing time, offering a personal aesthetic, hair, or beauty studio right in your back garden.

Our garden Studios are tailor-made, featuring a variety of double-glazed uPVC windows and door options like French, sliding, or bi-fold, all secured with multi-point locking systems. Owing to double glazing and hybris insulation in the walls, ceiling, and floor, our

Haon garden Studios are comfortable all year round, in any weather. Standard fittings include a radiator (upgradeable to air conditioning) and essential additions like extra electrical sockets and internet connectivity, placed according to your preference.

We can also accommodate the inclusion of a sink, toilet, or en suite, and offer non-plumbed sink options if preferable. A Haon garden Studio is an ideal solution for your beauty business, whether you're looking to free up a room, balance work and home life, or eliminate commute time, ultimately giving you more personal time.





HOBBY & CREATIVE STUDIOS

Sometimes you just need a place and space where you can enjoy your hobbies and explore your dreams!

Maybe there's simply not enough room in your home to contain that amazing train collection, those space-filling bikes, or to keep your sewing-machines and equipment, never mind the fabric, mannequin and ribbons to go along with them!

Or, you just want peace and quiet to create your paintings, or photograph those incredible portraits, in your very own studio?

Even if it's not something so creative and you just want somewhere to show off your valuable collection of fly-fishing gear and be the envy of all your friends, these are just a few reasons why our clients come to us!

We'll take your ideas and specifications, put our Haon Garden Room sparkle onto them, and create you the most beautiful garden Hobby Room or Studio.





BESPOKE DESIGNS

The beauty of Haon Garden Rooms being completely bespoke means we can create the perfect garden office, gym, studio, multi-use entertainment space or bar especially for you.

Whether you have an unusual shape, require a ramp for access, desire a particular colour or style, or need additional decking for your hot-tub, you name it, we design and create our garden rooms uniquely for you, and with your individual purpose in mind.

With a huge variety of windows and doors, all with locks for security, and a vast range of wood, hardy plank or composite colours, you won't be short on choices to create

a truly unique and beautiful exterior. Our creative craftsmen can even build a hidden door into timber fascia rooms, perfect for that additional storage space without compromising its aesthetical beauty.

So, a quirky shape at the back of your garden or a tree right where you want your decking to be is no problem for us! We find a way to work with your garden and nature so we can design the most amazing room for you.

No two Haon garden rooms are the same, and we take incredible pride in creating and building a garden room which brings our client's dreams to life!









BESPOKE INTERIOR DESIGN

We, at Haon Garden Rooms, believe that interior space is just as important as the exterior, and whilst we offer our clients incredible variety for the exterior, we also love to create the most amazing internal spaces for them too.

With the flexibility to create your internal space with additional rooms, be it for storage or an ensuite, we can build you a functional, yet incredibly beautiful, office, gym, studio, multi-use entertainment space or bar which will meet all your needs.

From built in bars with fridges, to specialist flooring, lighting and extra electrical sockets, supports for large flat-screen TVs, feature walls, ensuites, kitchens, etc, we build them all to fit in perfectly with your unique garden room.

BESPOKE INTERIOR DESIGN KITCHEN

Can a garden room have a plumbed in toilet, sink and shower?
Yes it can!

We offer two options:

- Plumbed-in and
- Non-plumbed-in

Due to the plumbing installation of pipework and waste required, there is an increased cost involved with the plumbed-in option, which varies according to the distance of your Garden Room from your house and/or water and sewage points.

However, if you would like to have plumbed-in water and waste, it is absolutely possible and something we do for many of our clients.

However, should you not wish to incur these additional installation costs, one of the better examples we can offer is a Pump Basin, whereby the sink works with a water pump that collects the water from a 20L water-can, feeding through an instant water heater, and collecting the wastewater into a separate 20L water-can.

This gives you hot water in a convenient sink which you can move to any location just as long as it has a power supply/socket.





HAND PICKED PARTNERS —

We choose very carefully who we partner with to provide our clients with their finishings (to compliment their garden room) as high quality materials, the latest innovative products and five star service is what we offer every single client.

Any partner we work with has the same high standards and endorses the same approach, making sure our clients are looked after throughout the life of their products.

From custom-made blinds to alternative sink options, and gym floorings to the very latest gym equipment, here are just a few of our partners we're proud to team up with.



CONCORDEBLINDS

Concorde Blinds is a family run business and like to keep it that way to ensure that their customers receive a personal experience every time.

Formed in 1978, they set one immovable goal – to consistently provide the very best in products and services.

www.concordeblinds.com



CUSTOMBASINS

Custom Basins is a small family run business founded by husband and wife team Niko and Annie.

Formed after what seemed an endless search to have hot and cold water in Annie's salon that had no access to a mains water connection.

Their unique product range are the perfect solution for any garden room without plumbing.

www.custombasins.co.uk



TRIBE ACTIVE UK

TRIBE Active UK was started by two best friends who had a dream to start offering the highest quality gym equipment out there.

Gym equipment that is high quality which use quality materials and workmanship but at a realistic and affordable price.

Above all they wanted to offer an unparalleled customer experience.

www.tribeactiveuk.com



HAON GARDEN ROOM GUARANTEE

Once your fabulous garden office, gym, studio, multi-use entertainment space or bar is built and completed, the relationship with Haon Garden Rooms doesn't stop when we hand over your keys to you.

In fact, we stand by our high-quality products, materials, and quality workmanship so much so that we provide you with a 10 year structural guarantee and 15 years roofing guarantee to back these.



THE HAON PROCESS

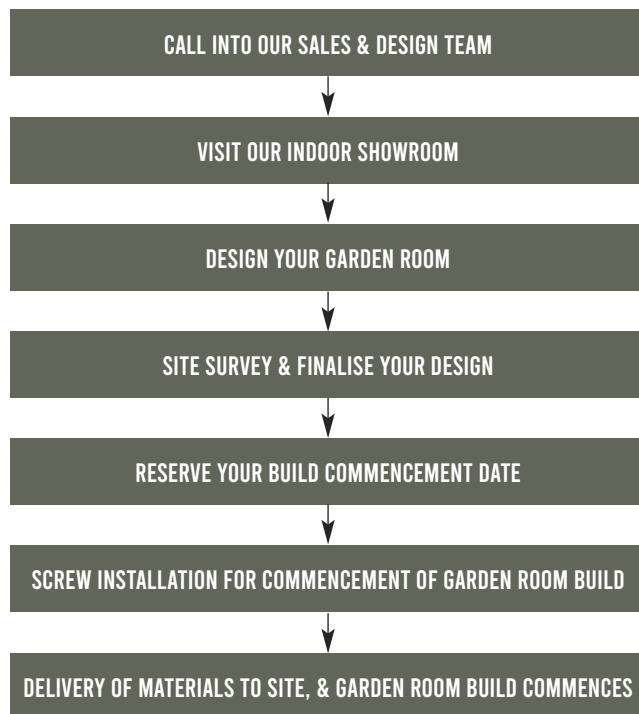

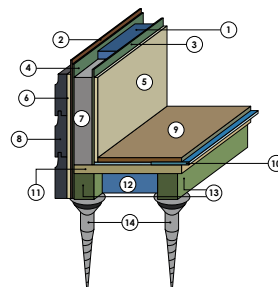
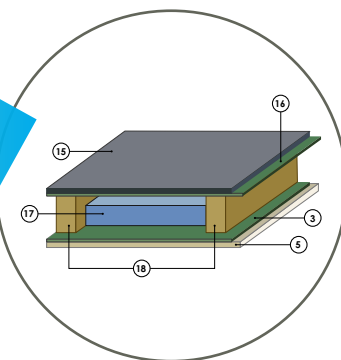

- | | |
|--------------------------------|-----------------------------|
| 1. 75mm Hybris Insulation | & 50mm x 100mm |
| 2. Breathable Membrane | C24 Timber Joists |
| 3. Vapour Barrier | 14. 1250mm Ground Screw |
| 4. 11mm OSB | 15. Rubber Roofing Membrane |
| 5. 12.5mm Plasterboard & Skim | 16. 18mm TG3 OSB |
| 6. 25mm x 50mm Batten | 17. 90mm Celotex |
| 7. 89mm x 38mm CLS Timber Stud | 18. 50mm x 150mm C24 Timber |
| 8. Hardie Plank/Cedar Cladding | |
| 9. 12mm Laminate Flooring | |
| 10. Laminate Underlay | |
| 11. 22mm Chipboard Flooring | |
| 12. 90mm Hybris Insulation | |
| 13. 75mm x 100mm C24 limber | |



TECHNICAL INFO

We believe that a garden room should be built to last! That is why all our materials are of the highest quality and all construction is carried out by our own construction teams onsite, all fully experienced and trained to the Haon way.

Nothing is flat-packed – not with Haon Garden Rooms! The foundation of all our garden rooms are constructed with stainless steel ground screws. This makes sure every installation has the most durable and sturdy base, and ensures they stay around for years to come.

The roof, walls and floor of all our garden rooms are all fully insulated which enables them to be used all year round, and are finished to the highest of standards with electrics, internet connections, and are professionally

plastered and decorated, including lighting and flooring.

And in addition to this, all our uPVC windows and French, sliding, or bi-fold doors, are all fitted with multi-point locks for added security.

OUR SHOWROOM

The best way to truly experience the quality and workmanship of our Garden Rooms is by visiting our fantastic showroom in Stagsden, Bedfordshire. Here you can touch and feel the materials we use, as well as be inspired by some of our designs, finishings and accessories.

We have examples of all the different materials, windows, doors and finishings we offer, but for that real wow factor we have a number of Garden Rooms built and fully accessorised to whet your appetite and feed your imagination!

We always make showroom visits by appointment so when you get here you can sit down

with one of our experts who will guide you through the process, and create your design to ensure you have a unique and truly personalised Garden Room.

From cedar finishes to coloured cladding, lighting choices, flooring and different room sizes, shapes and uses, our showroom is here to inspire you and help you to create the Garden Room of your dreams.



HOW TO FIND US



**UNIT 7,
KINSBOURNE FARM,
WICK END,
STAGSDEN,
BEDFORDSHIRE,
MK43 8TS**

CUSTOMER REVIEWS



WE WERE VERY IMPRESSED...

From the moment we visited the Haon showroom without an appointment we were very impressed. Even though the sales staff were not there, the staff who were working were very happy to show us around and answer as many questions as they could. Nothing was ever too much trouble.

Paul Kilby

CARRIED OUT BY EXPERTS..

From start to finish the Haon garden room we had designed and built was carried out by experts in their field. The building was built in-situ and the workmen were professional and close to the detail at all time resulting in a high quality finish and a beautiful addition to our home and garden.

Stephanie Blane

UTTERLY PROFESSIONAL...

When looking around for a garden room it became very clear that Haon were ahead of the game, in planning, the groundwork and construction. The whole process we extremely easy. Jason completely understood our needs and his team are master craftsmen.

Adam Kelly

HIGHLY RECOMMEND...

We honestly couldn't recommend Haon Garden Rooms anymore if we tried. They were very helpful from start to finish. The builders, plasterer, decorator, electricians and management team were all lovely people and very friendly and polite. Overall, we would highly recommend them.

The Femtrepreneur

100% HAPPY TO RECOMMEND...

Haon restored my faith in delivering great customer service. So many companies talk about this in all their marketing bumph but singularly fail to deliver. Not Haon! From start to finish we were blown away. In the lead in they were so helpful, no oversell just a clear desire to help us get what we needed.

Bill Hogan

DID A FANTASTIC JOB...

We had a small garden room built in a tight space but Haon did a fantastic job. Ashley and his team worked quickly and professionally and tidied up after themselves. Arrianna did a great follow up service to make sure we were happy and to give us all the necessary paperwork and a lovely thank you gift which was much appreciated.

Elaine Doyle

THE PRODUCT IS FANTASTIC...

I am overjoyed with the garden room Jason and the team built for me. From initial meetings to final hand over, everyone involved was extremely professional, knowledgeable and helpful. The quality of the product is fantastic, I would highly recommend this company. If you are thinking of investing in a garden room, Haon is the place to go.

Steve Nevard

I CAN'T RECOMMEND THEM HIGHLY ENOUGH..

The whole experience of working with Haon has been fantastic, and the finished product is outstanding. Everyone we encountered at Haon very clearly have huge passion for what they do and a real sense of care about their work. All of which is reflected in the finish and the final outcome.

Geoff Griffiths

OUR PEOPLE

Overseen by the incredibly client-focussed and talented Directors, Jason Mennie (Sales Director) and Steve Gray (Construction Director), each individual project is carefully designed, managed and constructed by our well-trained and hugely experienced teams.

With customer service as paramount, our sales and project teams are trained in-house on all of our garden room products and materials,

which enables us to provide the best support possible. As well as being some of the best in the business and highly experienced, our construction teams are fully trained in-house to our own, individual, high standards of craftsmanship.

In addition to this, our hard-working and dedicated customer service team have helped us build our well-deserved excellent and award winning reputation.





Our Office

Unit 7, Kinsbourne Farm, Wick End,
Stagsden Bedfordshire MK43 8TS



E-mail and Website

hello@haongardenrooms.co.uk
www.haongardenrooms.com



Phone Numbers

Main office: 01908 893215

